



**SUMMIT**  
BRICK COMPANY

## THIN BRICK TECHNICAL GUIDE



*INSPIRING ARCHITECTURAL ELEGANCE...*

*LAKWOOD BRICK AND SUMMIT BRICK*

Thank you for choosing Summit Brick Company to help enhance your project. This Technical Guide is meant to be a guide only as building codes vary by region. Please check with local building codes for proper requirements. Also, observe all safety precautions for construction when installing thin brick.

## Packaging and Weights

### Thin Brick

### Thin Brick Corners

#### Per Box Information

50 pieces  
7 square feet  
34 pounds

#### Per Box Information

25 pieces  
5 linear feet  
24 pounds

50 boxes per pallet  
1700 pounds per pallet

50 boxes per pallet  
1200 pounds per pallet

*PALLETS WEIGH 15 POUNDS EACH*

## ESTIMATION OF PRODUCT COVERAGE

### Thin Brick Calculation

1. Length X height = total square feet
2. Window/door length X height = total opening square feet
3. Total square feet - total opening square feet = total square feet needed
4. Total square feet X 7 = thin brick needed for project

### Thin Brick Corner Calculation

1. Measure height of all areas that outside corners are needed
2. Measure length and height of windows and doors that will use corners
3. Add all measurements up to get total linear feet of corners needed
4. Total Linear Feet X 5 = thin brick corners needed for project

## INTERIOR WALL

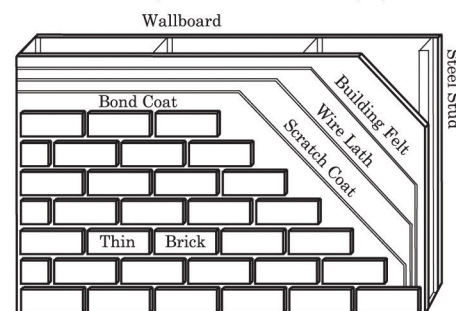

## EXTERIOR WALL

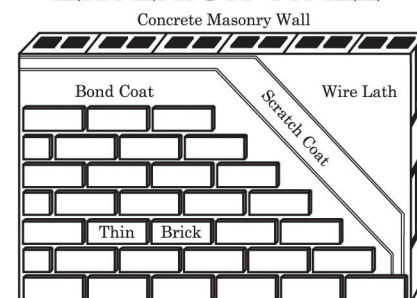

ACTUAL SIZE:  $\frac{1}{2} \times 2 \frac{1}{4} \times 7 \frac{5}{8}$

CORNER ACTUAL SIZE:  $\frac{1}{2} \times 3 \frac{1}{2} \times 2 \frac{1}{4} \times 7 \frac{5}{8}$

PER SQUARE FOOT: 7

CORNERS PER LINEAR FOOT: 5

*Summit Brick Company's thin brick meet ASTM C1088 type tbs and all Summit Brick company's tumbled thin brick meet astm C1088 type tba*

## CLEANING AND INSTALLATION INFORMATION

Thin brick should be kept clean during the installation process and any mortar on the brick should be removed gently with a damp sponge or soft bristle brush before it is allowed to set. We recommend following BIA technical note #20 for bucket and brush cleaning methods and BIA technical note #28C for installation. These technical notes can be found on [www.bia.org](http://www.bia.org) and can be easily downloaded. All acids should be avoided and if cleaning or installation assistance is needed, please contact your sales representative.



SUMMIT PLANT - 719.542.8278  
601 EAST 13TH STREET - PUEBLO, CO - 81001



**LAKWOOD**  
BRICK & TILE COMPANY

LAKWOOD PLANT - 303.238.5313  
1325 JAY STREET - LAKEWOOD, CO - 80214